



LICENSING SUB COMMITTEE

Monday, 7th March, 2016

10.30 am

Town Hall, Watford

Please note the start time of this meeting

Publication date: 26 February 2016

CONTACT

If you require further information or you would like a copy of this agenda in another format, e.g. large print, please contact Ian Smith/Alan Garside in Democracy and Governance on 01923 278376 or by email to legalanddemocratic@watford.gov.uk .

Welcome to this meeting. We hope you find these notes useful.

ACCESS

Access to the Town Hall is via the Customer Service Centre, accessed from the visitors' car park. Visitors may park in the staff car park after 4.00 p.m. and before 7.00 a.m. This is a Pay and Display car park; the current charge is £1.50 per visit.

The Committee Rooms are on the first floor of the Town Hall and a lift is available. Induction loops are available in the Committee Rooms and the Council Chamber.

TOILETS (including disabled)

Toilets are situated on the first floor, near to the Committee Rooms.

FIRE/EMERGENCY INSTRUCTIONS

In the event of a fire alarm sounding, vacate the building immediately following the instructions given by the Democratic Services Officer.

- Do not use the lifts
- Do not stop to collect personal belongings
- Go to the assembly point at the Pond and wait for further instructions
- Do not re-enter the building until authorised to do so.

MOBILE PHONES

Please ensure that mobile phones are switched off or on silent before the start of the meeting.

FILMING / PHOTOGRAPHY / RECORDING / REPORTING

Please note: this meeting might be filmed / photographed / recorded / reported by a party other than Watford Borough Council for subsequent broadcast or publication.

If you do not wish to have your image / voice captured you should let the Chair or Democratic Services Officer know before the start of the meeting.

An audio recording may be taken at this meeting for administrative purposes only.

COMMITTEE MEMBERSHIP

Councillors S Bolton, I Brown, J Brown, J Connal, K Crout, G Derbyshire, F Ewudo, M Haley, K Hastrick, M Hofman, M Mills, T Rogers, S Silver, M Watkin and S Williams

The Sub-Committee to comprise 3 members from those listed above.

AGENDA

PART A - OPEN TO THE PUBLIC

1. **COMMITTEE MEMBERSHIP/ ELECTION OF A CHAIR**
2. **DISCLOSURE OF INTERESTS (IF ANY)**
3. **APPLICATION FOR A NEW PREMISES LICENCE: WATFORD FOOTBALL CLUB STADIUM, VICARAGE ROAD, WATFORD, WD18 0ER** (Pages 5 - 44)

Report of the Head of Community and Customer Services.

This report asks the Sub-Committee to consider an application for a new premises licence following the receipt of representations.

PART A

Report to: Licensing Sub-Committee
Date of meeting: 7 March 2016
Report of: Head of Community and Customer Services
Title: Application for a new Premises Licence
Watford Association Football Club, Vicarage Road Stadium,
Vicarage Road, Watford WD18 0ER
15/02075/LAPRE

1.0 SUMMARY

1.1 An application for a new Premises Licence has been received from Watford Association Football Club to licence Vicarage Road Stadium for the sale of alcohol, the provision of regulated entertainment, and the provision of late night refreshment, on Mondays to Sundays. One representation has been received from a local resident.

2.0 RECOMMENDATIONS

2.1 That the Licensing Sub-Committee determines whether to grant the application (amended as appropriate for the promotion of the licensing objectives) as set out in the report.

Contact Officer:

For further information on this report please contact: Austen Young (Licensing Officer) telephone 01923 278474: email: austen.young@watford.gov.uk

Report approved by: Alan Gough, Head of Community and Customer Services

3.0 **APPLICATION**

3.1 Type of authorisation applied for
New Premises Licence.

3.2 Description of premises

The premises is described on the application form as follows:

‘Vicarage Road Stadium is a professional sports stadium operating under a General Safety Certificate issued by Hertfordshire County Council and a Licence to Admit Spectators issued by the Safety at Sports Grounds Authority. The stadium comprises of 4 spectator viewing stands each with concourses containing catering outlets from which alcohol is sold as well as enclosed hospitality areas from which alcohol is also sold.’

3.3 Under Policy LP1, this premises would best be defined as an ‘other entertainment venue’, where licensable activities are ancillary to the primary use of the premises as a sports stadium. Under Policy LP2, the premises is deemed to be situated within a residential area.

3.4 A map of the location of the premises is attached at appendix 1.

3.5 A plan showing the layout of the premises is attached at appendix 2.

3.6 The premises does currently benefit from an existing licence which is attached at appendix 3. A new licence is required because the premises are looking to increase the licensed area.

3.7 Licensable activities

Licensable activity	Applied for
Plays	
Films	✓
Indoor sports events	
Boxing or wrestling entertainment	✓
Live music	✓
Recorded music	✓
Performances of dance	✓
Anything of a similar description to live or recorded music or dance	✓
Provision of late night refreshment	✓
Sale by retail of alcohol for consumption on the premises	✓
Sale by retail of alcohol for consumption off the premises	✓

3.8 For comparison, the only activity which is not permitted under the existing licence for the stadium is the provision of boxing or wrestling entertainment.

The initial application was requesting indoor sporting events as a licensable activity but this was later withdrawn by the applicant.

3.9 Licensable hours

The requested hours are detailed in the table below.

	Regulated Entertainment	Late Night Refreshment	Sale of Alcohol
Monday	10:00 – 00:30	23:00 – 00:30	10:00 – 00:00
Tuesday	10:00 – 00:30	23:00 – 00:30	10:00 – 00:00
Wednesday	10:00 – 00:30	23:00 – 00:30	10:00 – 00:00
Thursday	10:00 – 00:30	23:00 – 00:30	10:00 – 00:00
Friday	10:00 – 01:30	23:00 – 01:30	10:00 – 01:00
Saturday	10:00 – 01:30	23:00 – 01:30	10:00 – 01:00
Sunday	10:00 – 23:00	N/A	10:00 – 23:00

3.10 The initial application was requesting a terminal hour for alcohol sales of 00:30 Monday to Thursday, and 01:30 on Friday and Saturday. However, these hours were amended by the applicant to those detailed above. For comparison, these hours are no different to those on the current licence.

3.11 It is also proposed that the alcohol hours on New Year's Eve are to be 10:00 – 01:00 if 1 January is a Friday or Saturday, and 10:00 – 00:00 on all other days.

4.0 **BACKGROUND INFORMATION**

4.1 The following background information is known about these premises:

4.2 Designated premises supervisor

Mr Glyn Evans, since 12 November 2012.

4.3 Current licences held

The premises holds a current licence with reference 12/01030/LAPRE (see appendix 3). This licence has been in force since 24 July 2012, when it was transferred to Watford Association Football Club Ltd from the previous holders, Watford Leisure Plc. The premises has been licensed under the Licensing Act 2003 since the Act came into force in November 2005, and so the licence benefits from hours which pre-date the existing licensing policy, which was first adopted in 2011. Prior to November 2005, a Justices' Licence under the Licensing Act 1964 was in force permitting the sale of alcohol.

4.4 Closing date for representations

10 February 2016

4.5 Public notice published in newspaper

22 January 2016

4.6 Visits and Enforcement action

There have been no complaints to the licensing authority about this

premises, and therefore there has been no need to visit the premises or undertake any enforcement action.

5.0 PROMOTION OF LICENSING OBJECTIVES.

5.1 Although this application is for a new licence, the applicant has indicated within their operating schedule that they intend to duplicate the conditions of the existing licence and therefore did not propose any additional measures, with the exception of permitting the use of glass drinking vessels within the enclosed hospitality suites. These conditions are reproduced at paragraph 8.4.

6.0 REPRESENTATIONS

6.1 Responsible Authorities

The Police and environmental health negotiated conditions with the applicant and therefore did not submit formal representations. These conditions are reproduced at paragraph 8.5. No comments were received from any other responsible authority.

6.2 Residents

Representations have been received from the residents listed below.

Name	Address	Representative Body (Yes/No)	Relevance to which licensing objective(s)
Not provided	18 Liverpool Road, Watford WD18 0DJ	No	Crime and disorder, public nuisance

6.4 This representation is attached at appendix 4.

6.5 The representation states that granting this application will lead to disorder in the vicinity of the stadium, crimes against nearby residential properties, and disturbance from the regulated entertainment and other licensable activities.

7.0 POLICY CONSIDERATIONS

7.1 The following provisions of the Licensing Act 2003 apply to this application:

- Sections 17 and 18 (Application for premises licence):
Section 17 details the process which the applicant must have followed for the application to be considered valid. Section 18 describes the process by which an application for a premises licence is determined, including where relevant representations have been made as in this case.
- The Licensing Act 2003 (Hearings) Regulations 2005 (as amended)
These regulations detail how hearings should be conducted to determine applications submitted under the Licensing Act.

7.2 Statutory guidance

The following provisions of the Secretary of State's guidance (March 2015) apply to this application:

- Paragraphs 8.33 - 8.41:
These paragraphs explain how steps should be taken to promote the licensing objectives. It is for the Sub-Committee to decide in light of this guidance whether the measures offered by the applicant are appropriate to promote the licensing objectives. It is equally important to use the same measure when looking at any steps requested by a party making representations against an application.
- Paragraphs 9.30 – 9.40:
These paragraphs explain that hearings should be focused on the steps considered appropriate to the promotion of the licensing objectives, as well as how appropriate weight must be attributed to the steps to promote the licensing objectives, the representations presented by all parties, the statutory guidance, and the licensing authority's statement of licensing policy.
- Paragraphs 9.41 – 9.43
These paragraphs explain that when determining applications, the authority's determination should be evidence-based, as well as how to assess if a step is 'appropriate' for the promotion of the licensing objectives.
- Chapter 10:
This chapter looks at best practice in relation to conditions that may be attached to a premises licence should it be believed that such conditions are appropriate to promote the licensing objectives. Any additional conditions requested by any party should be considered with reference to this chapter.

7.3 Statement of licensing policy

The following paragraphs of the licensing authority's statement of licensing policy apply to this application:

- Policy LP1 – Premises Definitions
Under this policy, the premises are best defined as an other entertainment venue.
- Policy LP2 – Location and Operation of Premises
This policy sets out the approach to licensing premises when relevant representations are received, notwithstanding that each application is considered on its own merits. This premises is situated within a residential area and as such this policy states that other entertainment venues 'may be limited to midnight'.

- Policy LP6 – Prevention of Crime and Disorder
Under this policy the Sub-Committee will consider any necessary measures to deal with the potential for crime and disorder where relevant representations have been received.
- Policy LP8 – Prevention of Public Nuisance
Under this policy the Sub-Committee will consider any appropriate measures to deal with the potential for public nuisance and/or anti-social behaviour where relevant representations have been received.
- Policy LP11 – Representations About Applications
This policy recommends the type of information that should be included in a representation. It also explains how representations will be dealt with.

7.4 The Sub-Committee is reminded of their duty under the Crime and Disorder Act 1998 to consider the crime and disorder implications of their decisions and the authority's responsibility to co-operate in the reduction of crime and disorder in the Borough.

7.5 The Sub-Committee is reminded that the Human Rights Act 1998 guarantees the right to a fair hearing for all parties in the determination of their civil rights. The Act also provides for the protection of property, which may include licences in existence, and the protection of private and family life.

8.0 **CONDITIONS**

8.1 Members will be aware that an operating schedule forms part of the licensing process. This document outlines what activities are proposed, the opening hours, and how the activities will be managed particularly in respect of the licensing objectives.

8.2 The most critical part of the operating schedule is the steps taken by the applicant to promote the four licensing objectives. Applicants are always reminded to take careful consideration as to what is entered in this section as whatever is proposed will be translated as conditions on the licence.

8.3 Applicants should give consideration to the local area and reflect this in their application. It should demonstrate an awareness of the local community, local crime and disorder issues, and the local environment.

8.4 Conditions consistent with the operating schedule
Officers propose that the following conditions are consistent with the operating schedule submitted by the applicant, the licence which is currently in force at the premises (adapted where possible from the licensing authority's pool of model conditions), and are appropriate for the promotion of the licensing objectives:

1. Roving sales persons may sell intoxicating liquor only:

- (i) in the area at the foot of the banks of seating in the North, East, South and West stands at the stadium, or in the areas of existing outlets on the concourses within the stands;
 - (ii) to persons attending any event with the exception of football matches;
 - (iii) not more than four sales persons may be operating in each stand at any one time;
 - (iv) sales persons must be 18 years of age or over and must receive appropriate training in the sale of alcohol;
 - (v) sales persons must not operate on the stairs or in the gangways and vomitories;
 - (vi) sales persons may only sell beer and lager;
 - (vii) sales persons must deliver alcohol only into the hands of those persons who are purchasing alcohol and not into the hands of any third party.
2. All external handling of glass waste will take place after 0900 hours and before 2300 hours.
 3. The premises licence holder shall make available to customers the contact details of local taxi or private hire vehicle firms. Any ordered taxis shall be directed to use the Director's car park to collect customers without sounding their horns.

8.5 Conditions proposed by the responsible authorities

Following discussions between the applicant, the Police, and environmental health, the following conditions have been accepted by the applicant:

1. All alcohol shall be supplied in lightweight plastic or similar containers, except that glass containers are permitted within the enclosed hospitality suites. The licence holder shall ensure that no glass containers are permitted within the general public areas.
2. Where Vicarage Road stadium is to be used for an outdoor event which requires a new, or amended, sports ground safety certificate (excluding any certificate relating to the playing of football or rugby), the licence holder shall notify the licensing authority that such an application has been submitted within three working days of submission.
3. Where an outdoor event requires a new, or amended, sports ground safety certificate (excluding any certificates relating to the playing of football or rugby), the licence holder shall provide to the licensing authority a copy of the event management plan which has been agreed

by Hertfordshire Fire & Rescue Service and Hertfordshire Constabulary at least 28 days before the proposed event.

4. Where an outdoor event requires a new, or amended, sports ground safety certificate (excluding any certificates relating to the playing of football or rugby), the licence holder shall provide to the licensing authority a copy of the noise management plan which has been agreed by the environmental health authority of Watford Borough Council at least 28 days before the proposed event.

As these conditions were accepted by the applicant, they should be treated as being volunteered as part of the operating schedule.

8.6 Conditions proposed by objectors

No conditions have been proposed by the resident.

8.7 Pool of Model Conditions

In addition to any conditions proposed by the responsible authorities or interested parties, the licensing authority also has its own pool of model conditions that may help mitigate the concerns raised in the representations.

- 8.8 Officers do not believe that there are any additional conditions within the pool of model conditions which would be appropriate in this case. The representation from the resident does mention noise and nuisance from the regulated entertainment, but a condition has been agreed with environmental health to agree a noise management plan to reduce the impact from any large scale entertainment events, such as any music concerts or boxing matches. There are also concerns about crime and disorder but there is little information provided in the representations to assess if there any measures which the club can implement to address these concerns.

- 8.9 This does not restrict the Sub-Committee's power to attach conditions from the pool (amended or otherwise) if they consider that they are appropriate, proportionate, justifiable and within the applicant's power to comply with.

- 8.10 A draft Premises Licence which reflects this application and the conditions which are proposed in the preceding paragraphs is attached at appendix 5.

9.0 **OFFICERS' OBSERVATIONS**

- 9.1 It is noted that this application is for a new licence, and that the hours requested are outside of the recommended hours for this type of premises as recommended under Policy LP2.

- 9.2 Members are advised that this application represents no extension on the hours permitted under the existing licence for the stadium. The addition of the licensable activity of boxing and wrestling entertainment is something that may have been requested through a full variation application. However, the changes to the layout of the stadium, required in part to bring the stadium in line with the standards of the Premier League, which also resulted in an

increase to the licensed area, were not suitable for a variation application. This left a new licence application as the only available option. The increase in the licensed area, and the changes to the stadium, are quite substantial.

9.3 Members are able to depart from policy in circumstances where there are justifiable reasons for doing so, and after considering the individual merits of the application before them.

9.4 Officers have attempted to contact the local resident in order to discuss the concerns raised in their representation, and to allow them to expand upon their concerns. This was also a chance to identify whether the concerns were with regards to the crowds leaving football matches, which are not necessarily matters which can be addressed through licensing. However, at the time of writing this report, officers had not received any reply.

9.5 The representation against this application makes reference to how granting this licence will lead to 'untold disturbance and disorder in the vicinity of the premises'. There is little information provided to expand upon these concerns. Members are reminded of paragraph 2.20 of the statutory guidance, which states:

"Beyond the immediate area surrounding the premises, these are matters for the personal responsibility of individuals under the law. An individual who engages in anti-social behaviour is accountable in their own right. However, it would be perfectly reasonable for a licensing authority to impose a condition, following relevant representations, that requires the licence holder or club to place signs at the exits from the building encouraging patrons to be quiet until they leave the area, or that, if they wish to smoke, to do so at designated places on the premises instead of outside, and to respect the rights of people living nearby to a peaceful night."

9.6 The officers' observations and the comments regarding the representations are in no way meant to bind Members. They are for guidance only and Members may attach whatever weight they see fit.

9.7 The Sub-Committee have a duty to "have regard" to the licensing policy but are not bound by it. However, should Members wish to depart from the policy then detailed reasons for this must be given as part of any decision.

9.8 In determining this application, the Sub-Committee must have regard to the representations and take such steps as it considers appropriate for the promotion of licensing objectives. The steps are:

- (a) grant the application in full.
- (b) modify the conditions of the licence volunteered by the applicant in the operating schedule, by altering or omitting or adding them.
- (c) reject the whole or part of the application.

Appendices

Appendix 1 – location plan

Appendix 2 – plans of premises

Appendix 3 – current licence (12/01030/LAPRE)

Appendix 4 – representation

Appendix 5 – draft licence (15/02075/LAPRE)

Background Papers

The following background papers were used in the preparation of this report. If you wish to inspect or take copies of the background papers, please contact the officer named on the front page of the report.

Licensing Act 2003

Amended guidance issued under section 182 of the Licensing Act 2003
(Home Office March 2015)

Licensing Act (Hearings) Regulations 2005

Watford Borough Council Licensing Policy (November 2013 – November 2018)

Watford Borough Council Pool of Model Conditions (March 2013)

File Reference

Watford FC

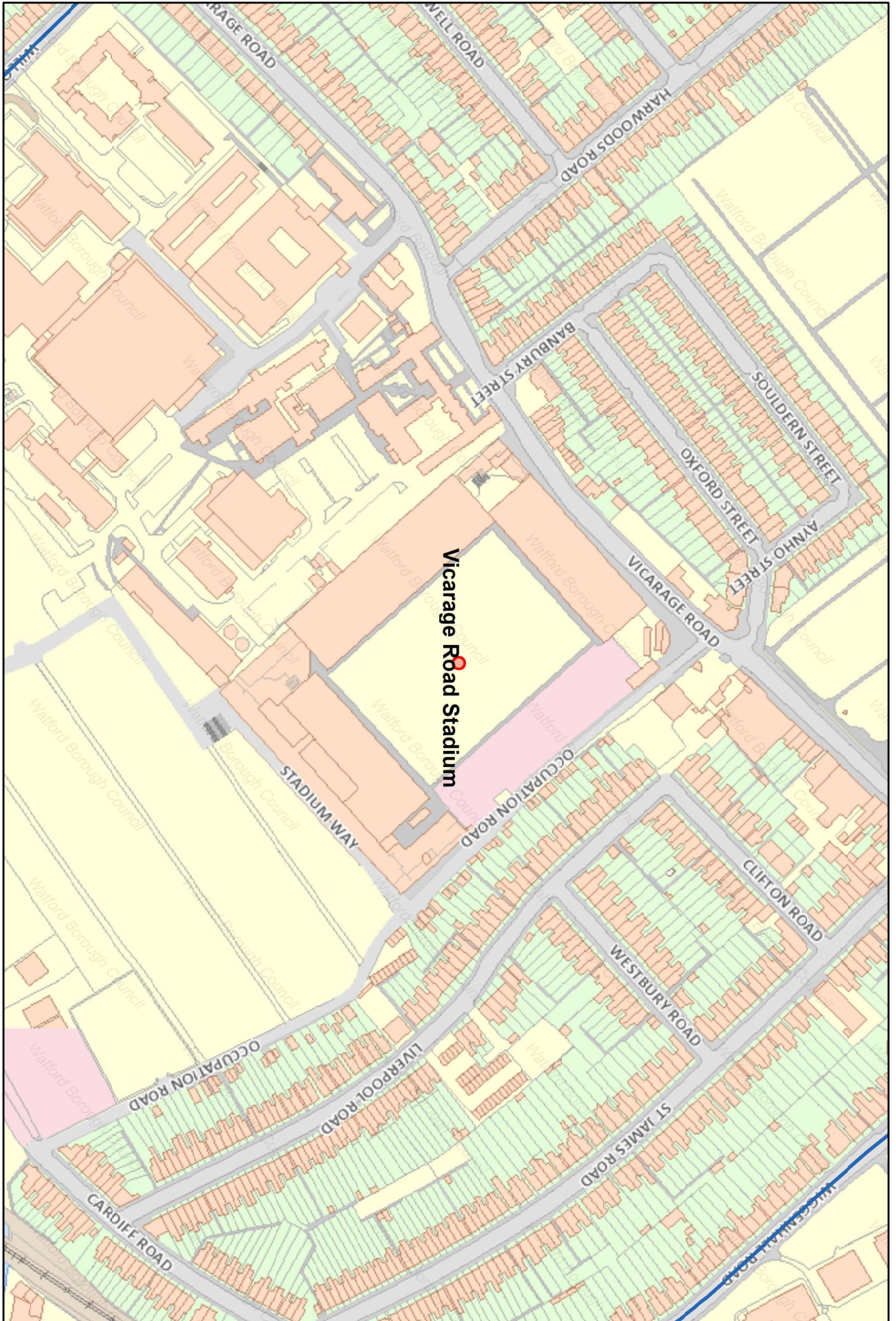

Appendix 1 - Location Plan
Date: 19/02/2016

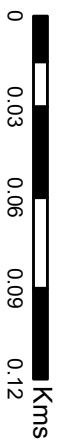

Scale 1:2,500

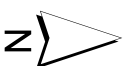

SEE SEPARATE PLANS
① NORTH EAST CORNER STOUND FLOOR
② NORTH EAST CORNER FIRST FLOOR

SEE SEPARATE PLAN
PREGY & RAVICES FAMILY FACILITIES

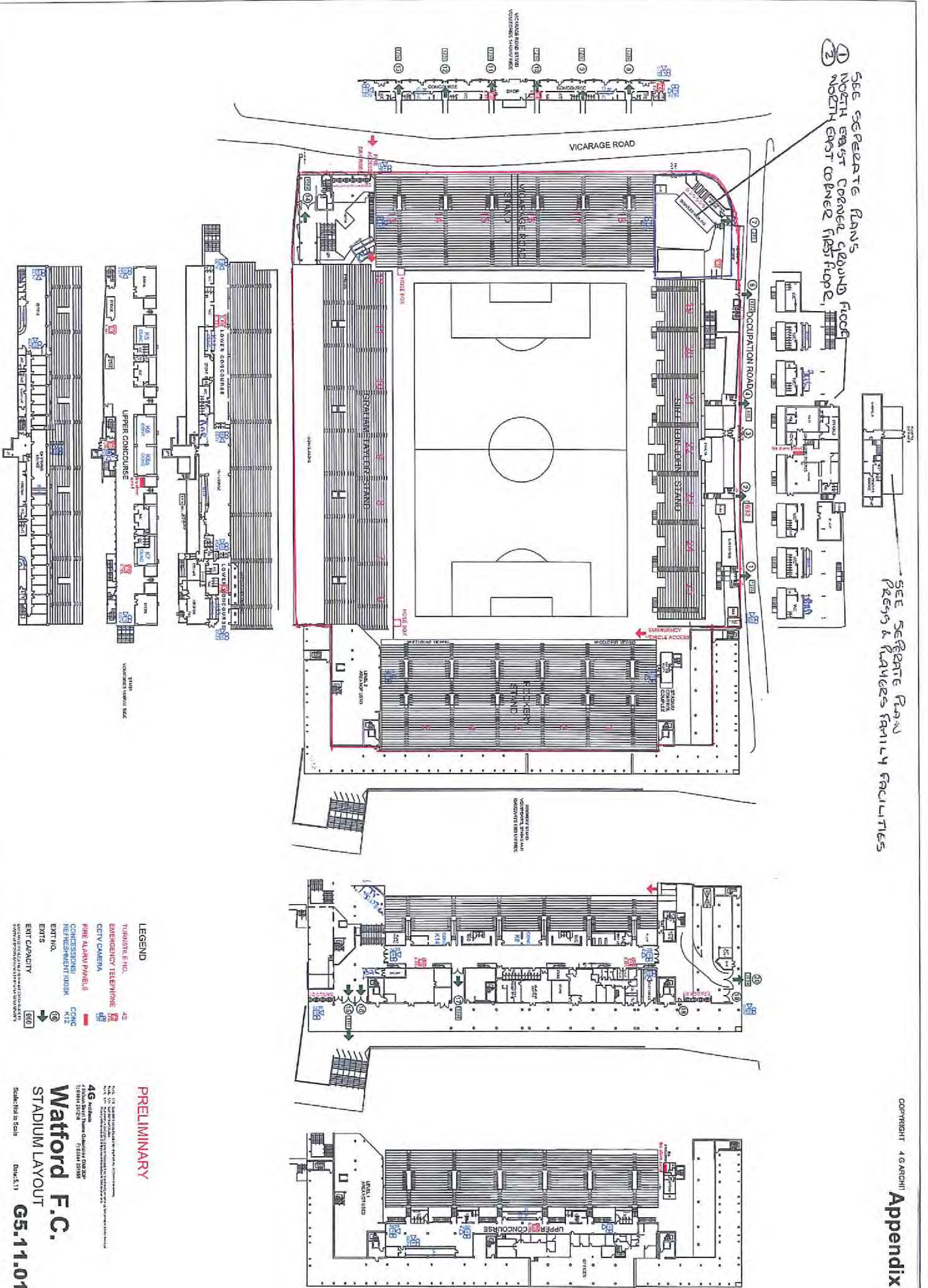

PRELIMINARY

- LEGEND**
- FINISHLINE FNO. 42
 - EMERGENCY TELEPHONE 43
 - CCTV CAMERA 44
 - PIRE ALARMS/PANELS 45
 - CONCESSIONS 46
 - RESTROOMS 47
 - ENTR. 48
 - ENTR. NO. 49
 - ENTR. CAPACITY 50

Watford F.C.
STADIUM LAYOUT
G5.11.01
Scale: 1/100
Date: 5.11

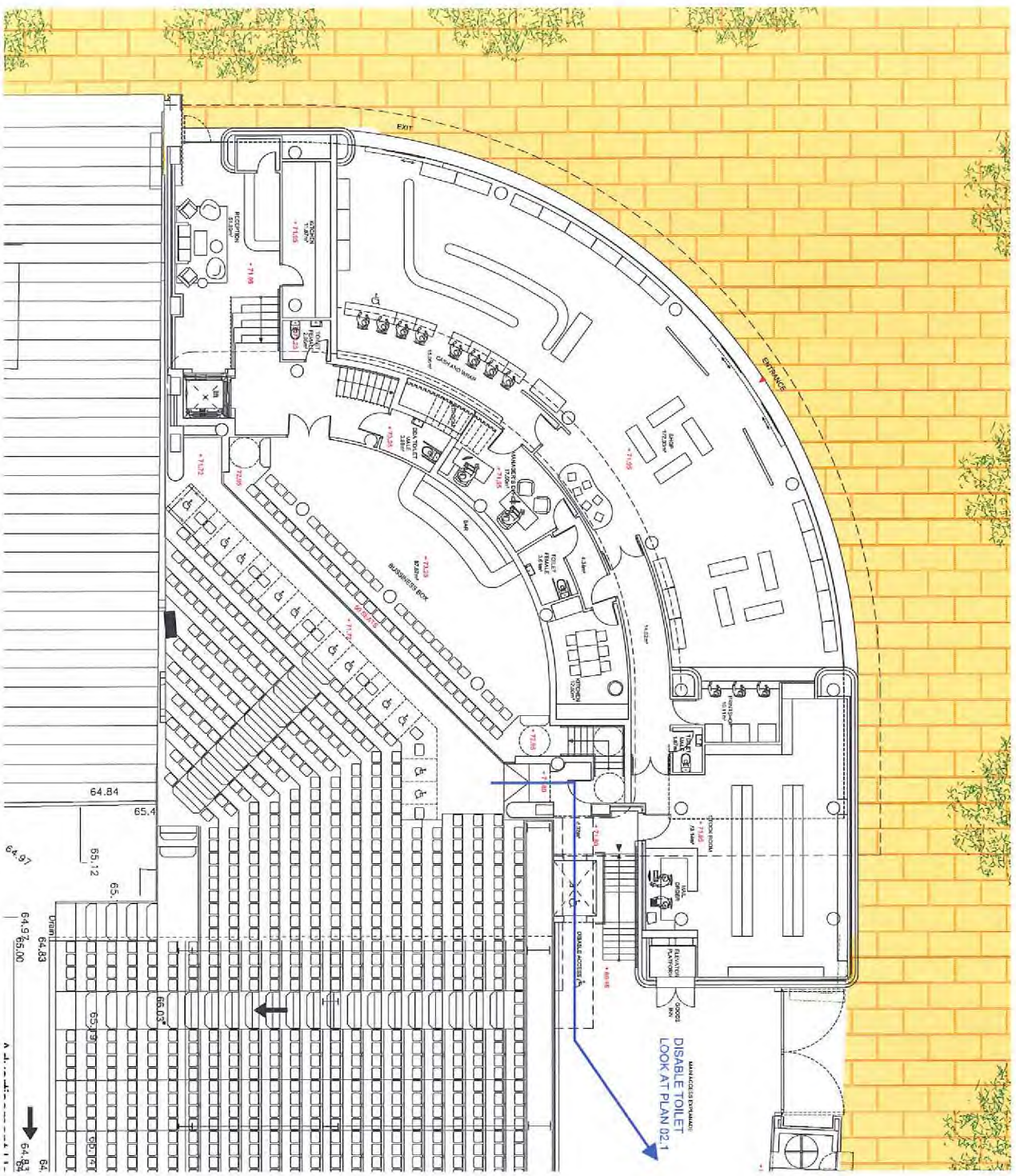

DATE	REV.	REVISION	TYPE OF MODIFICATION
2015 06 26	1	G. SANCHEZ	

ALL MEASUREMENTS MUST BE CHECKED ON SITE. THE COMPANY SHALL BE RESPONSIBLE FOR ANY ERRORS OR OMISSIONS. THIS DOCUMENT BELONGS TO ESTUDIO SANCHEZ GAUDO. ANY REPRODUCTION OR USE WITHOUT THE WRITTEN AUTHORIZATION OF THE ARCHITECT IS STRICTLY PROHIBITED. THIS DOCUMENT IS NOT VALID FOR CONSTRUCTION WITHOUT THE ARCHITECT'S SIGNATURE AND SEAL.

WATFORD FC
 BUILDING EXTENSIONS
 DEVELOPMENT & FACILITIES
 AT VICARAGE ROAD STADIUM

WATFORD FC
 BUILDING EXTENSIONS
 DEVELOPMENT & FACILITIES
 AT VICARAGE ROAD STADIUM

WATFORD FC
 BUILDING EXTENSIONS
 DEVELOPMENT & FACILITIES
 AT VICARAGE ROAD STADIUM

**NEW WATFORD FC STORE,
 BUSSINESS BOXES AND NEW
 STANDS (NORTH EAST CORNER):
 GROUND FLOOR LAYOUT PLAN**

DATE: 2015 06 26
 SCALE: 1/100
 SHEET NUMBER: 01.1
 ARCHITECT: GUILLERMO SANCHEZ GAUDO

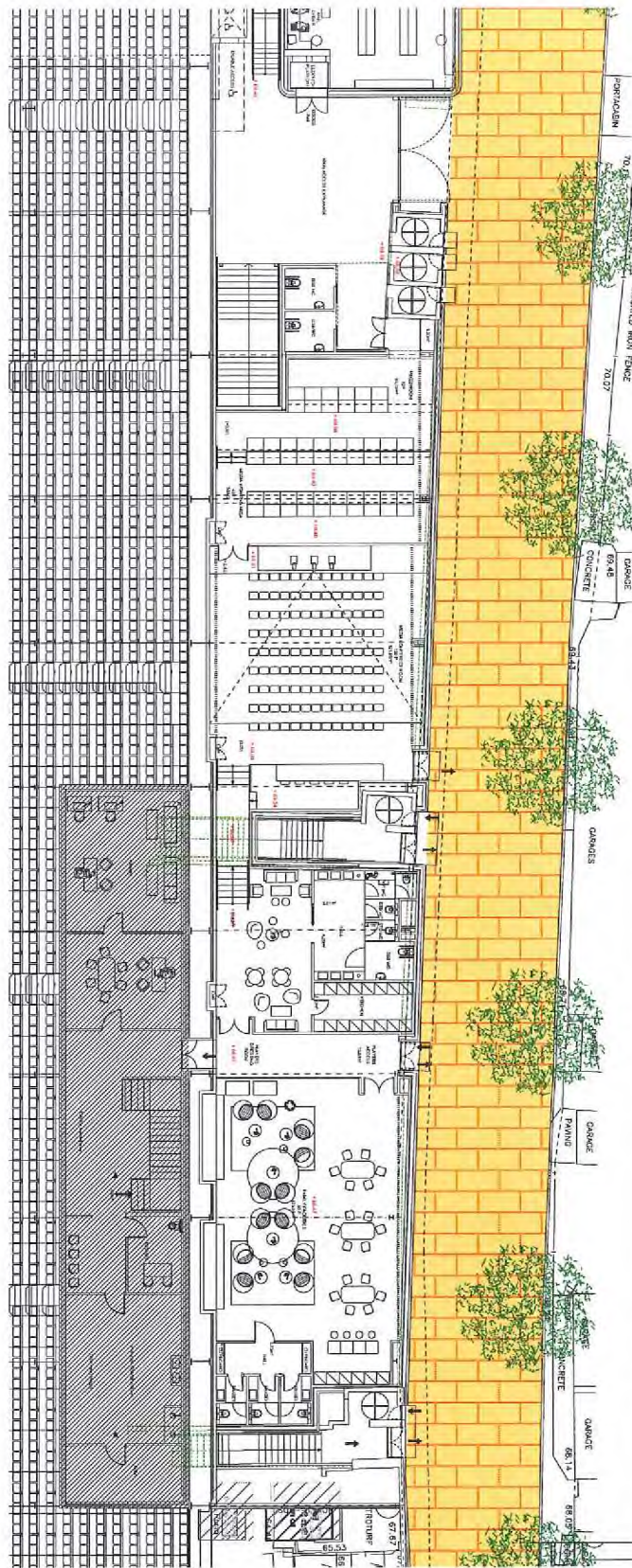
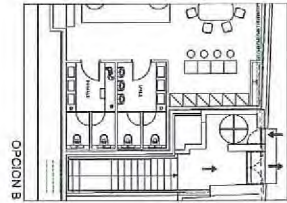

DATE	NO.	REVISION	TYPE OF MODIFICATION
2015.08.28	1	CLARIFIED	

WATFORD FC
BUILDING EXTENSIONS
DEVELOPMENT & FACILITIES
AT VIKINGHOLE ROAD ST ALBANS

DATE: 2015.08.28
 DRAWING NO: 02.1

PRESS AND PLAYERS' FAMILY
FACILITIES EAST SIDE STIRLTON
JOHN STAND: GROUND FLOOR AND
ROOF LAYOUT PLAN

DESIGNED BY: GABRIELINO SANCHEZ DAUD

**Licensing Act 2003
Schedule 12
Part A**

Regulation 33,34

Premises Licence

Premises Licence Number

12/01030/LAPRE

Part 1 – Premises Details

Postal address of premises, or if none, ordnance survey map reference or description, including Post Town, Post Code

Watford Football Club
Vicarage Road Stadium
Vicarage Road
Watford
WD18 0ER

Telephone number 01923 496000

Where the licence is time limited the dates

From 12 November 2012

Licensable activities authorised by the licence and the times the licence authorises the carrying out of licensable activities

On and off-premises alcohol sales	Monday, Tuesday, Wednesday, Thursday	10:00 - 00:00
Late Night Refreshment	Monday, Tuesday, Wednesday, Thursday	23:00 - 00:30
Exhibition of a Film	Monday, Tuesday, Wednesday, Thursday	10:00 - 00:30
Performance of Live Music	Monday, Tuesday, Wednesday, Thursday	10:00 - 00:30
Performance of Recorded Music	Monday, Tuesday, Wednesday, Thursday	10:00 - 00:30
Performance of Dance	Monday, Tuesday, Wednesday, Thursday	10:00 - 00:30
Other Entertainment falling within Act	Monday, Tuesday, Wednesday, Thursday	10:00 - 00:30
On and off-premises alcohol sales	Friday and Saturday	10:00 - 01:00
Late Night Refreshment	Friday and Saturday	23:00 - 01:30
Exhibition of a Film	Friday and Saturday	10:00 - 01:30
Performance of Live Music	Friday and Saturday	10:00 - 01:30
Performance of Recorded Music	Friday and Saturday	10:00 - 01:30
Performance of Dance	Friday and Saturday	10:00 - 01:30
Other Entertainment falling within Act	Friday and Saturday	10:00 - 01:30
On and off-premises alcohol sales	Sunday	10:00 - 23:00

Premises Licence page 1

P:\Procedures\Licensing\Licensing Act 2003\Licensing Applications\Premises Licence Applications\Watford Football Club\Part A - Change of DPS 12.11.12.doc

Exhibition of a Film	Sunday	10:00 - 23:00
Performance of Live Music	Sunday	10:00 - 23:00
Performance of Recorded Music	Sunday	10:00 - 23:00
Performance of Dance	Sunday	10:00 - 23:00
Other Entertainment falling within Act	Sunday	10:00 - 23:00
On and off-premises alcohol sales	New Year's Eve	10:00 - 00:00
(Terminal hour of 01:00 if 1 January is a Friday or Saturday, and 22:30 if a Sunday)		

The opening hours of the premises		
Monday, Tuesday, Wednesday, Thursday		10:00 - 00:30
Friday and Saturday		10:00 - 01:30
Sunday		10:00 - 23:00
New Year's Eve		10:00 - terminal hour for alcohol sales on 1 January

<p>Where the licence authorises supplies of alcohol whether these are on and / or off supplies</p> <p>Alcohol may be sold for consumption on and off the premises.</p>

Part 2

Name, (registered) address, telephone number and email (where relevant) of holder of premises licence

Watford Association Football Club Ltd
Vicarage Road Stadium
Vicarage Road
Watford
WD18 0ER

Registered number of holder, for example company number, charity number (where applicable)

Registered Business Number 104194

Name, address and telephone number of designated premises supervisor where the premises licence authorises for the supply of alcohol

Glyn Evans
[Redacted for this report]

Personal licence number and issuing authority of personal licence held by designated premises supervisor where the premises licence authorises for the supply of alcohol

Personal Licence Number: DAC 031215
Licensing Authority: Dacorum Borough Council

Annex 1 – Mandatory conditions

1. No supply of alcohol may be made under the premises licence –
 - (a) at a time when there is no designated premises supervisor in respect of the premises licence, or
 - (b) at a time when the designated premises supervisor does not hold a personal licence or his personal licence is suspended.
2. Every supply of alcohol under the premises licence must be made or authorised by a person who holds a personal licence.
3. The admission of children under 18 to any film exhibition must be restricted in accordance with any recommendation made by the film classification body specified in section 4, Video Recordings Act 1984 unless the licensing authority notifies the holder of the premises licence that recommendations made by the licensing authority must be followed instead.
4. (1) The responsible person must ensure that staff on relevant premises do not carry out, arrange or participate in any irresponsible promotions in relation to the premises.

(2) In this paragraph, an irresponsible promotion means any one or more of the following activities, or substantially similar activities, carried on for the purpose of encouraging the sale or supply of alcohol for consumption on the premises—
 - (a) games or other activities which require or encourage, or are designed to require or encourage, individuals to—
 - (i) drink a quantity of alcohol within a time limit (other than to drink alcohol sold or supplied on the premises before the cessation of the period in which the responsible person is authorised to sell or supply alcohol), or
 - (ii) drink as much alcohol as possible (whether within a time limit or otherwise);
 - (b) provision of unlimited or unspecified quantities of alcohol free or for a fixed or discounted fee to the public or to a group defined by a particular characteristic in a manner which carries a significant risk of undermining a licensing objective;
 - (c) provision of free or discounted alcohol or any other thing as a prize to encourage or reward the purchase and consumption of alcohol over a period of 24 hours or less in a manner which carries a significant risk of undermining a licensing objective;
 - (d) selling or supplying alcohol in association with promotional posters or flyers on, or in the vicinity of, the premises which can reasonably be considered to condone, encourage or glamorise anti-social behaviour or to refer to the effects of drunkenness in any favourable manner;
 - (e) dispensing alcohol directly by one person into the mouth of another (other than where that other person is unable to drink without assistance by reason of disability).
5. The responsible person must ensure that free potable water is provided on request to customers where it is reasonably available.
6. (1) The premises licence holder or club premises certificate holder must ensure that an age verification policy is adopted in respect of the premises in relation to the sale or supply of alcohol.

(2) The designated premises supervisor in relation to the premises licence must ensure that the supply of alcohol at the premises is carried on in accordance with the age verification policy.

(3) The policy must require individuals who appear to the responsible person to be under 18 years of age (or such older age as may be specified in the policy) to produce on request, before being served alcohol, identification bearing their photograph, date of birth and either—

- (a) a holographic mark, or
- (b) an ultraviolet feature.

7. The responsible person must ensure that—

- (a) where any of the following alcoholic drinks is sold or supplied for consumption on the premises (other than alcoholic drinks sold or supplied having been made up in advance ready for sale or supply in a securely closed container) it is available to customers in the following measures—
 - (i) beer or cider: ½ pint;
 - (ii) gin, rum, vodka or whisky: 25 ml or 35 ml; and
 - (iii) still wine in a glass: 125 ml;
- (b) these measures are displayed in a menu, price list or other printed material which is available to customers on the premises; and
- (c) where a customer does not in relation to a sale of alcohol specify the quantity of alcohol to be sold, the customer is made aware that these measures are available.

8. A relevant person shall ensure that no alcohol is sold or supplied for consumption on or off the premises for a price which is less than the permitted price.

For the purposes of this condition -

- (a) “duty” is to be construed in accordance with the Alcoholic Liquor Duties Act 1979;
- (b) “permitted price” is the price found by applying the formula –

$$P = D + (D \times V)$$

where -

- (i) P is the permitted price,
 - (ii) D is the amount of duty chargeable in relation to the alcohol as if the duty were charged on the date of the sale or supply of the alcohol, and
 - (iii) V is the rate of value added tax chargeable in relation to the alcohol as if the value added tax were charged on the date of the sale or supply of the alcohol;
- (c) “relevant person” means, in relation to premises in respect of which there is in force a premises licence -
 - (i) the holder of the premises licence,
 - (ii) the designated premises supervisor (if any) in respect of such a licence, or
 - (iii) the personal licence holder who makes or authorises a supply of alcohol under such a licence;
 - (d) “relevant person” means, in relation to premises in respect of which there is in force a club premises certificate, any member or officer of the club present on the premises in a capacity which enables the member or officer to prevent the supply in question; and
 - (e) “value added tax” means value added tax charged in accordance with the Value Added Tax Act 1994.

9. Where the permitted price would (apart from this paragraph) not be a whole number of pennies, the price given by that sub-paragraph shall be taken to be the price actually given by that sub-paragraph rounded up to the nearest penny.
10. (1) Sub-paragraph (2) applies where the permitted price on a day (“the first day”) would be different from the permitted price on the next day (“the second day”) as a result of a change to the rate of duty or value added tax.

(2) The permitted price which would apply on the first day applies to sales or supplies of alcohol which take place before the expiry of the period of 14 days beginning on the second day.

Annex 2 – Conditions consistent with the Operating Schedule

- 1 The following conditions apply to those areas on the attached plan (including the south-east car park) where sales of alcohol are allowed:
 - (a) Alcohol shall not be sold or supplied in the Rous Stand Executive Boxes otherwise than to:
 - (i) occupiers of the Executive Boxes under formal licence and their guests
 - (ii) bona fide guests attending association football and rugby football matches
 - (iii) bona fide guests attending by ticket or invitation any other function organised in the premises.
 - (b) Roving sales persons may sell intoxicating liquor only:
 - (i) in the area at the foot of the banks of seating in the North, East, South and West (Rous) Stands at the stadium; or
 - (ii) in the areas of existing outlets on the concourses within the Stands, and only to persons attending rugby football matches in the stadium; or to persons attending any other event in the stadium;
 - (iii) not more than four sales persons may be operating in each Stand at any one time;
 - (iv) sales persons must be 18 years of age or over and must receive appropriate training in the sale of alcohol;
 - (v) sales persons must not operate on the stairs or in the gangways and vomitories;
 - (vi) sales persons may only sell beer and lager;
 - (vii) sales persons must deliver alcohol only into the hands of those persons who are purchasing alcohol and not into the hands of any third party.
 - (c) All alcohol shall be supplied in light plastic or similar containers.
- 2 The following conditions apply to all licensable activities as appropriate:
 - (a) Music will be turned off when the sale of alcohol ends.
 - (b) All external handling of glass waste will take place after 0900 hours and before 2300 hours.
 - (c) A dedicated taxi service will be used when customers request this service. The taxi service will use the Director's car park to collect customers without sounding their horns.

Annex 3 – Conditions attached after a hearing by the licensing authority

There was no hearing held for the application of this premises licence/club premises certificate.

Annex 4 – Plans

Drawing no: 2660 (F) 14 dated 31.07.07

Premises Licence page 9

P:\Procedures\Licensing\Licensing Act 2003\Licensing Applications\Premises Licence Applications\Watford Football Club\Part A - Change of DPS 12.11.12.doc

Mr Young
Watford Borough Council
WD17 3EX

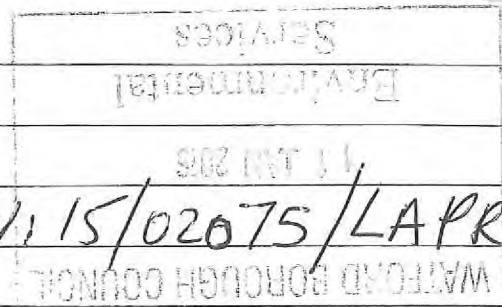

Your ref: 15/02075/LAPRE

Date: 31/12/2015

Dear Mr Young
re: Licensing Act 2003
Watford Football Club, Vicarage Road Stadium, Vicarage
Road, Watford - Application for A New Premises Licence

I am putting pen to paper to object against the above application being granted to Watford Football Club due to the impact it will have on my Wellbeing and personal property.

Granting such a licence to Watford Football Club will lead to:

- untold disturbance and disorder in the vicinity and crimes against residential properties backing onto Occupation Road.
- Too much late night noise
- Properties backing onto Occupation Road will be greatly affected by the regulated Entertainment and other aspects of this licence activities.

Yours sincerely

18' Liverpool Rd

**Licensing Act 2003
Schedule 12
Part A**

Regulation 33,34

Premises Licence

Premises Licence Number

15/02075/LAPRE

Part 1 – Premises Details

Postal address of premises, or if none, ordnance survey map reference or description, including Post Town, Post Code

Watford Football Club
Vicarage Road Stadium
Vicarage Road
Watford
WD18 0ER

Telephone number 01923 496000

Where the licence is time limited the dates

From 7 March 2015

Licensable activities authorised by the licence and the times the licence authorises the carrying out of licensable activities

Sale of alcohol	Monday, Tuesday, Wednesday, Thursday	10:00 - 00:00
	Friday and Saturday	10:00 - 01:00
	Sunday	10:00 - 23:00
	New Year's Eve (if 1 January a Friday or Saturday)	10:00 - 01:00
	New Year's Eve (if 1 January any other day)	10:00 - 00:00
Late Night Refreshment	Monday, Tuesday, Wednesday, Thursday	23:00 - 00:30
	Friday and Saturday	23:00 - 01:30
Exhibition of a Film	Monday, Tuesday, Wednesday, Thursday	10:00 - 00:30
	Friday and Saturday	10:00 - 01:30
	Sunday	10:00 - 23:00
Performance of Live Music	Monday, Tuesday, Wednesday, Thursday	10:00 - 00:30
	Friday and Saturday	10:00 - 01:30
	Sunday	10:00 - 23:00

Premises Licence page 1

P:\Procedures\Licensing\Licensing Act 2003\Licensing Applications\Premises Licence Applications\Watford Football Club - new 2015\Draft Licence.doc

Performance of Recorded Music	Monday, Tuesday, Wednesday, Thursday Friday and Saturday Sunday	10:00 - 00:30 10:00 - 01:30 10:00 - 23:00
Performance of Dance	Monday, Tuesday, Wednesday, Thursday Friday and Saturday Sunday	10:00 - 00:30 10:00 - 01:30 10:00 - 23:00
Entertainment similar to Music and Dance	Monday, Tuesday, Wednesday, Thursday Friday and Saturday Sunday	10:00 - 00:30 10:00 - 01:30 10:00 - 23:00

The opening hours of the premises		
Monday, Tuesday, Wednesday, Thursday	09:00 - 00:30	
Friday and Saturday	09:00 - 01:30	
Sunday	09:00 - 23:00	

Where the licence authorises supplies of alcohol whether these are on and / or off supplies		
Alcohol may be sold for consumption on and off the premises.		

DRAFT

Part 2

Name, (registered) address, telephone number and email (where relevant) of holder of premises licence

Watford Association Football Club Ltd
Vicarage Road Stadium
Vicarage Road
Watford
WD18 0ER

Registered number of holder, for example company number, charity number (where applicable)

Registered Business Number 104194

Name, address and telephone number of designated premises supervisor where the premises licence authorises for the supply of alcohol

Glyn Evans
[Redacted for this report]

Personal licence number and issuing authority of personal licence held by designated premises supervisor where the premises licence authorises for the supply of alcohol

Personal Licence Number: DAC 031215
Licensing Authority: Dacorum Borough Council

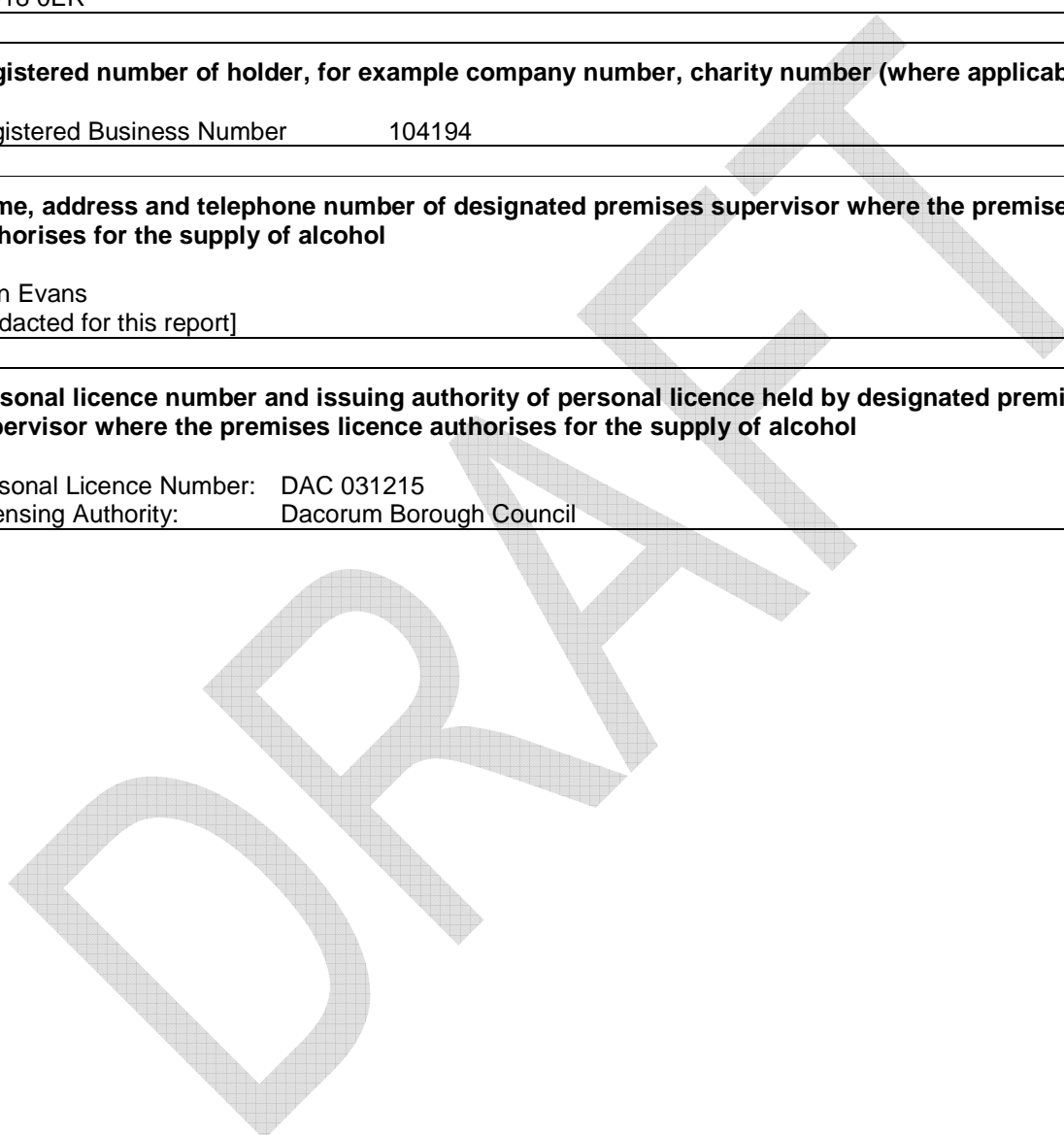

Annex 1 – Mandatory conditions

1. No supply of alcohol may be made under the premises licence –
 - (a) at a time when there is no designated premises supervisor in respect of the premises licence, or
 - (b) at a time when the designated premises supervisor does not hold a personal licence or his personal licence is suspended.
2. Every supply of alcohol under the premises licence must be made or authorised by a person who holds a personal licence.
3. The admission of children under 18 to any film exhibition must be restricted in accordance with any recommendation made by the film classification body specified in section 4, Video Recordings Act 1984 unless the licensing authority notifies the holder of the premises licence that recommendations made by the licensing authority must be followed instead.
4. (1) The responsible person must ensure that staff on relevant premises do not carry out, arrange or participate in any irresponsible promotions in relation to the premises.

(2) In this paragraph, an irresponsible promotion means any one or more of the following activities, or substantially similar activities, carried on for the purpose of encouraging the sale or supply of alcohol for consumption on the premises—
 - (a) games or other activities which require or encourage, or are designed to require or encourage, individuals to—
 - (i) drink a quantity of alcohol within a time limit (other than to drink alcohol sold or supplied on the premises before the cessation of the period in which the responsible person is authorised to sell or supply alcohol), or
 - (ii) drink as much alcohol as possible (whether within a time limit or otherwise);
 - (b) provision of unlimited or unspecified quantities of alcohol free or for a fixed or discounted fee to the public or to a group defined by a particular characteristic in a manner which carries a significant risk of undermining a licensing objective;
 - (c) provision of free or discounted alcohol or any other thing as a prize to encourage or reward the purchase and consumption of alcohol over a period of 24 hours or less in a manner which carries a significant risk of undermining a licensing objective;
 - (d) selling or supplying alcohol in association with promotional posters or flyers on, or in the vicinity of, the premises which can reasonably be considered to condone, encourage or glamorise anti-social behaviour or to refer to the effects of drunkenness in any favourable manner;
 - (e) dispensing alcohol directly by one person into the mouth of another (other than where that other person is unable to drink without assistance by reason of disability).
5. The responsible person must ensure that free potable water is provided on request to customers where it is reasonably available.
6. (1) The premises licence holder or club premises certificate holder must ensure that an age verification policy is adopted in respect of the premises in relation to the sale or supply of alcohol.

(2) The designated premises supervisor in relation to the premises licence must ensure that the supply of alcohol at the premises is carried on in accordance with the age verification policy.

(3) The policy must require individuals who appear to the responsible person to be under 18 years of age (or such older age as may be specified in the policy) to produce on request, before being served alcohol, identification bearing their photograph, date of birth and either—

- (a) a holographic mark, or
- (b) an ultraviolet feature.

7. The responsible person must ensure that—

- (a) where any of the following alcoholic drinks is sold or supplied for consumption on the premises (other than alcoholic drinks sold or supplied having been made up in advance ready for sale or supply in a securely closed container) it is available to customers in the following measures—
 - (i) beer or cider: ½ pint;
 - (ii) gin, rum, vodka or whisky: 25 ml or 35 ml; and
 - (iii) still wine in a glass: 125 ml;
- (b) these measures are displayed in a menu, price list or other printed material which is available to customers on the premises; and
- (c) where a customer does not in relation to a sale of alcohol specify the quantity of alcohol to be sold, the customer is made aware that these measures are available.

8. A relevant person shall ensure that no alcohol is sold or supplied for consumption on or off the premises for a price which is less than the permitted price.

For the purposes of this condition -

- (a) “duty” is to be construed in accordance with the Alcoholic Liquor Duties Act 1979;
- (b) “permitted price” is the price found by applying the formula –

$$P = D + (D \times V)$$

where -

- (i) P is the permitted price,
 - (ii) D is the amount of duty chargeable in relation to the alcohol as if the duty were charged on the date of the sale or supply of the alcohol, and
 - (iii) V is the rate of value added tax chargeable in relation to the alcohol as if the value added tax were charged on the date of the sale or supply of the alcohol;
- (c) “relevant person” means, in relation to premises in respect of which there is in force a premises licence -
 - (i) the holder of the premises licence,
 - (ii) the designated premises supervisor (if any) in respect of such a licence, or
 - (iii) the personal licence holder who makes or authorises a supply of alcohol under such a licence;
 - (d) “relevant person” means, in relation to premises in respect of which there is in force a club premises certificate, any member or officer of the club present on the premises in a capacity which enables the member or officer to prevent the supply in question; and
 - (e) “value added tax” means value added tax charged in accordance with the Value Added Tax Act 1994.

9. Where the permitted price would (apart from this paragraph) not be a whole number of pennies, the price given by that sub-paragraph shall be taken to be the price actually given by that sub-paragraph rounded up to the nearest penny.
10. (1) Sub-paragraph (2) applies where the permitted price on a day (“the first day”) would be different from the permitted price on the next day (“the second day”) as a result of a change to the rate of duty or value added tax.

(2) The permitted price which would apply on the first day applies to sales or supplies of alcohol which take place before the expiry of the period of 14 days beginning on the second day.

DRAFT

Annex 2 – Conditions consistent with the Operating Schedule

The following conditions are considered by officers to be consistent with the Operating Schedule submitted with this application, reference 15/02075/LAPRE:

1. Roving sales persons may sell intoxicating liquor only:
 - (i) in the area at the foot of the banks of seating in the North, East, South and West stands at the stadium, or in the areas of existing outlets on the concourses within the stands;
 - (ii) to persons attending any event with the exception of football matches;
 - (iii) not more than four sales persons may be operating in each stand at any one time;
 - (iv) sales persons must be 18 years of age or over and must receive appropriate training in the sale of alcohol;
 - (v) sales persons must not operate on the stairs or in the gangways and vomitories;
 - (vi) sales persons may only sell beer and lager;
 - (vii) sales persons must deliver alcohol only into the hands of those persons who are purchasing alcohol and not into the hands of any third party.
2. All external handling of glass waste will take place after 0900 hours and before 2300 hours.
3. The premises licence holder shall make available to customers the contact details of local taxi or private hire vehicle firms. Any ordered taxis shall be directed to use the Director's car park to collect customers without sounding their horns.
4. All alcohol shall be supplied in lightweight plastic or similar containers, except that glass containers are permitted within the enclosed hospitality suites. The licence holder shall ensure that no glass containers are permitted within the general public areas.
5. Where Vicarage Road stadium is to be used for an outdoor event which requires a new, or amended, sports ground safety certificate (excluding any certificate relating to the playing of football or rugby), the licence holder shall notify the licensing authority that such an application has been submitted within three working days of submission.
6. Where an outdoor event requires a new, or amended, sports ground safety certificate (excluding any certificates relating to the playing of football or rugby), the licence holder shall provide to the licensing authority a copy of the event management plan which has been agreed by Hertfordshire Fire & Rescue Service and Hertfordshire Constabulary at least 28 days before the proposed event.
7. Where an outdoor event requires a new, or amended, sports ground safety certificate (excluding any certificates relating to the playing of football or rugby), the licence holder shall provide to the licensing authority a copy of the noise management plan which has been agreed by the environmental health authority of Watford Borough Council at least 28 days before the proposed event.

Annex 3 – Conditions attached after a hearing by the licensing authority

There have not been any additional conditions proposed to be attached in response to the representation against this application.

However, this does not restrict the Sub-Committee’s power to attach conditions from the licensing authority’s pool of conditions (amended or otherwise) or to compose their own conditions if they consider that they are appropriate, proportionate, justifiable, and within the applicant’s power to comply with.

DRAFT

Annex 4 – Plans

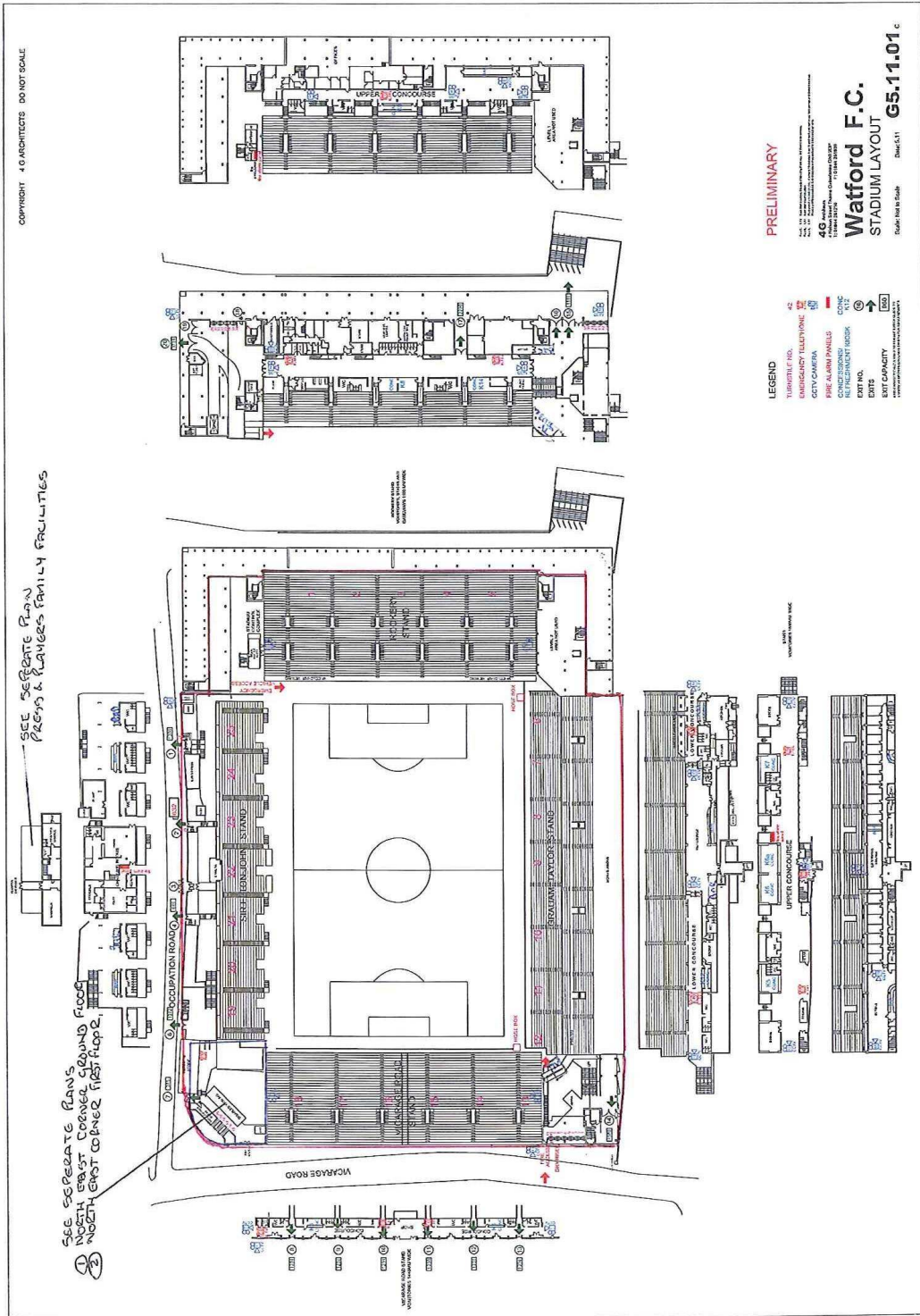

Premises Licence page 9

P:\Procedures\Licensing\Licensing Act 2003\Licensing Applications\Premises Licence Applications\Watford Football Club - new 2015\Draft Licence.doc

DISABLED TOILET LOOKOUT PLAN 001

DATE: 2015 08 26
 REV: 1
 BY: G. SANCHEZ
 TYPE OF MODIFICATION: NEW

DATE	REV	BY	TYPE OF MODIFICATION
2015 08 26	1	G. SANCHEZ	NEW

WATFORD FC
 BUILDING EXTENSIONS
 DEVELOPMENT & FACILITIES
 AT VIKINGE ROAD STADIUM
 001 - 000

PROJECT TITLE:
 NEW WATFORD FC STORE,
 BUSINESS BOXES AND NEW
 STANDS (NORTH EAST CORNER):
 GROUND FLOOR LAYOUT PLAN

DATE: 2015 08 26
 TIME: 11:00
 DRAWING NO: 01/1

DESIGNED BY: GUILHERMO SANCHEZ OLIVEIRA
 CHECKED BY: [Signature]

ALL WATFORD FC STORES ARE THE PROPERTY OF WATFORD FC STORES LTD. ALL RIGHTS RESERVED. NO PART OF THIS DOCUMENT IS TO BE REPRODUCED OR TRANSMITTED IN ANY FORM OR BY ANY MEANS, ELECTRONIC OR MECHANICAL, WITHOUT PERMISSION IN WRITING FROM WATFORD FC STORES LTD.

DATE: 2015 08 26

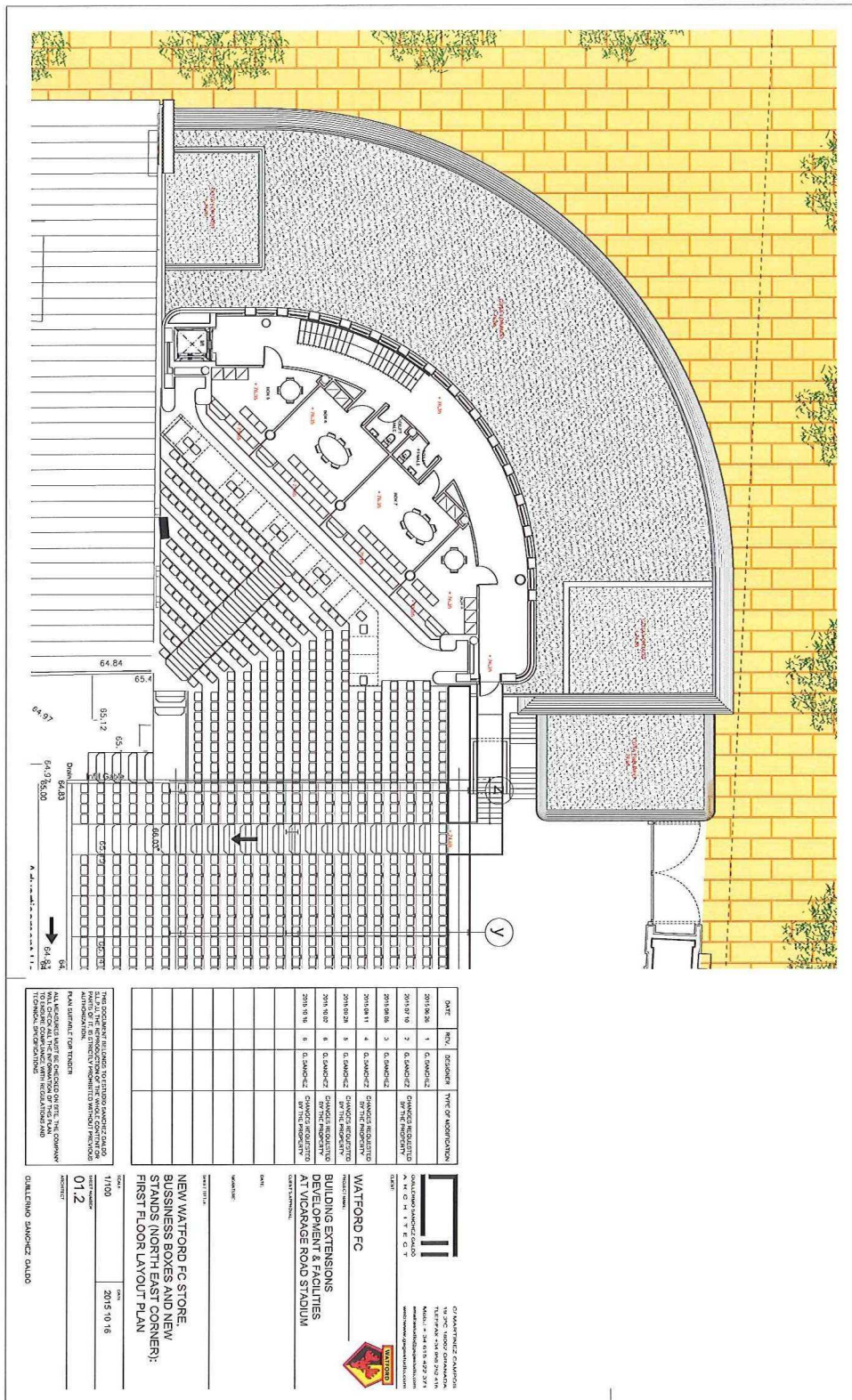

DATE	REVISION	TYPE OF MODIFICATION
2015/06/26	1	05. SANITICIZ
2015/07/02	2	05. SANITICIZ
2015/08/06	3	05. SANITICIZ
2015/08/11	4	05. SANITICIZ
2015/08/28	5	05. SANITICIZ
2015/09/02	6	05. SANITICIZ
2015/09/06	8	05. SANITICIZ

WATFORD FC
BUILDING EXTENSIONS
DEVELOPMENT & FACILITIES
AT VICARAGE ROAD STADIUM
 (SEEY DEVELOPMENT)

DATE: 1/1/00
 PROJECT NO: 01.2
 DRAWING NO: 2015.10.16

NEW WATFORD FC STORE,
 BUSINESS BOXES AND NEW
 STANDS (NORTH EAST CORNER):
 FIRST FLOOR LAYOUT PLAN

DATE: 2015.10.16

PROJECT NO: 01.2

CLIENT: GILBERTO MANOCCO

THIS DOCUMENT IS SUBJECT TO THE STANDARD CONDITIONS OF SALE AND CONTRACT DOCUMENTS WHICH APPLY TO THE DEVELOPMENT. ALL MODIFICATIONS MUST BE CHECKED ON SITE. THE COMPANY TAKES NO RESPONSIBILITY FOR THE ACCURACY OF THE INFORMATION PROVIDED HEREIN.

